

TW811

REV.	DESCRIPTION	DATE	ENG	ECO #	APPR
1	CREATE DRAWING	26FEB08	PP		MB
2	FAN PART NUMBER TO EF	5MAR08	PP		MB
3	CHANGE FAN MOUNT ITEM 3, ADD ITEM 2	14MAR08	PP		MB

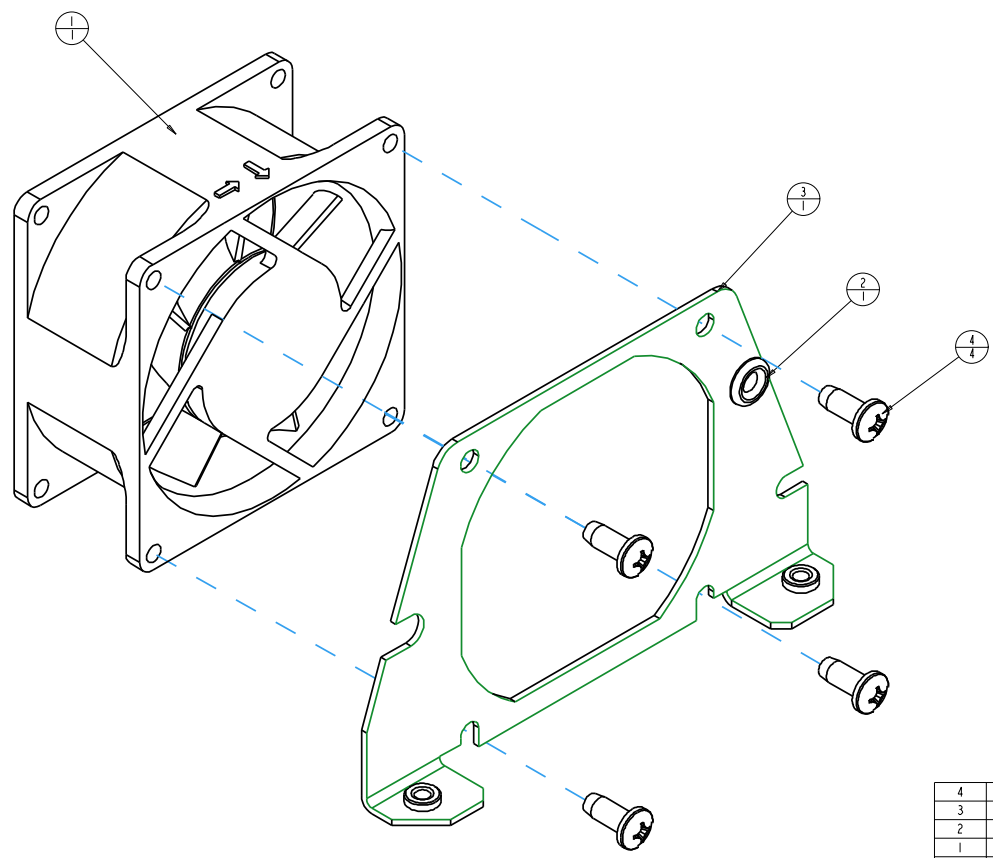

NOTES:
1. NOTE FAN ORIENTATION IN THE ASSEMBLY.

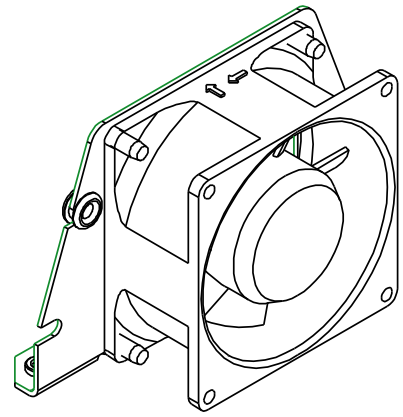

ITEM NO.	QTY.	FILENAME	PART NO.	REV	DESCRIPTION
4	4	SCREW10-14PPF500	90709062	.	SCREW, #10 PHIL PAN 1/2 PLASTITE S2
3	1	TW669	99260521	-	MOUNT, FAN, ELECTRONIC ENCLOSURE, SHOWGUN
2	1	GROMMET_25_STYRENE	90410061	1	GROMMET, 3/16 X 1/4
1	1	SUNON_80_X_80_38_AXIAL_FAN	80270038EF	.	FAN ASSY, 80X80X38 HI-FLOW

UNLESS OTHERWISE SPECIFIED		RELEASE DATE:	CE:	 2105 GRACY FARMS LANE AUSTIN, TEXAS 78158 (512) 836-2242 FAX (512) 832-4128 http://www.highend.com	
DIMENSIONAL TOLERANCES:		ENG: MIKE BELL	QA:		
0 PLACE DECIMAL = ±0.38		ME:	DRW: PETE PHILLIPS		
1 PLACE DECIMAL = ±0.25		MEG:			
2 PLACE DECIMALS = ±0.13		DESCRIPTION:		FAN ASSEMBLY, INTAKE	
ANGLES = ±0.5°		MATERIAL:		FINISH:	
FOR PAINTED PARTS REFER TO		TBD			
ENG. SPEC. MANUAL WI-0592					
ALL COMPONENTS, MATERIALS AND FINISHES TO BE RoHS COMPLIANT					
MIN. DRAFT		INTERPRET DIMENSIONS PER	SI	PART NO.	DRAWING NO.
MIN. RADI		ASME Y14.5M-1994	METRIC	INTERNAL	TW811
FLATNESS		THIRD ANGLE PROJECTION	A1		
THICKNESS		DIMENSIONS ARE IN MILLIMETERS			
VOLUME				DO NOT SCALE	SCALE: 1:000
					SHEET: 1 OF 1

PROPRIETARY NOTICE:
THIS DOCUMENT CONTAINS CONFIDENTIAL AND PROPRIETARY INFORMATION OF HIGH END SYSTEMS INC., (ALSO DBA LIGHTWAVE RESEARCH) AND IS GIVEN TO THE RECEIVER IN CONFIDENCE. THE RECEIVER ACCEPTS AND AGREES THAT, EXCEPT AS AUTHORIZED BY HIGH END SYSTEMS, THE RECEIVER WILL NOT PERMIT THE USE OF THE DOCUMENT OR ANY COPY THEREOF OR THE INFORMATION THEREIN, WILL NOT COPY OR PERMIT COPYING THE DOCUMENT WILL NOT DISCLOSE TO OTHERS EITHER THE DOCUMENT OR THE INFORMATION THEREIN, AND WILL UPON COMPLETION OF THE NEED TO RETURN THE DOCUMENT, OR UPON DEMAND, RETURN THE DOCUMENT WITHOUT RETAINING ANY OF THE INFORMATION CONTAINED THEREIN IN ANY FORM WHATSOEVER.